

# AVAILABLE FOR LEASE

## Retail Space in Alpharetta



### 3960 Old Milton Parkway., Alpharetta, GA 30005

\* **Size:** 1,462 RSF  
\* **Rate:** \$14.50/SF MG Net of Janitorial, Electricity & CAM  
\* Spaces can be combined or separate

- Flexible Lease Terms
- Available Now
- Retail Use
- Ideal for Neighborhood Retail Users
- Excellent Signage on Old Milton Pkwy.
- Brokers Protected

**Ted Schwartz**  
404.869.2606  
ted@joelandgranot.com

For complete details, please visit: [www.joelandgranot.com](http://www.joelandgranot.com)

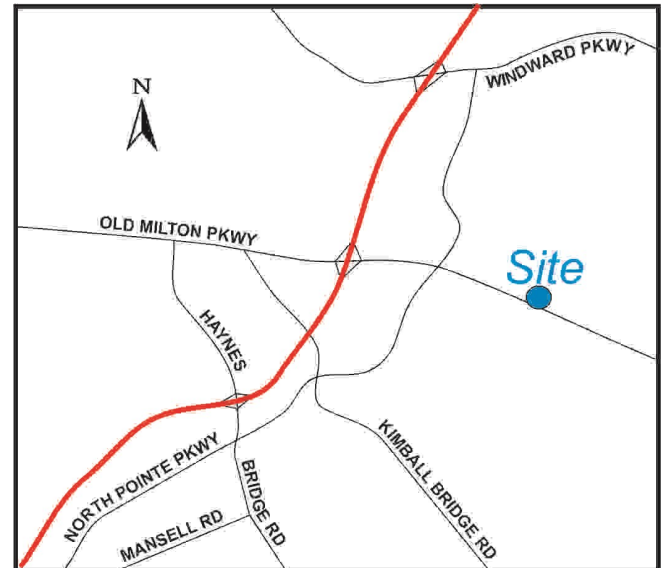

**JOEL & GRANOT**  
COMMERCIAL REAL ESTATE

962 Howell Mill Road, Atlanta, GA 30318  
(ph) 404.869.2600 | (fax) 404.869.2601

The information was obtained from sources we assume are reliable. We do

# 3960 Old Milton Pkwy, Alpharetta, GA 30005

## Floor Plan

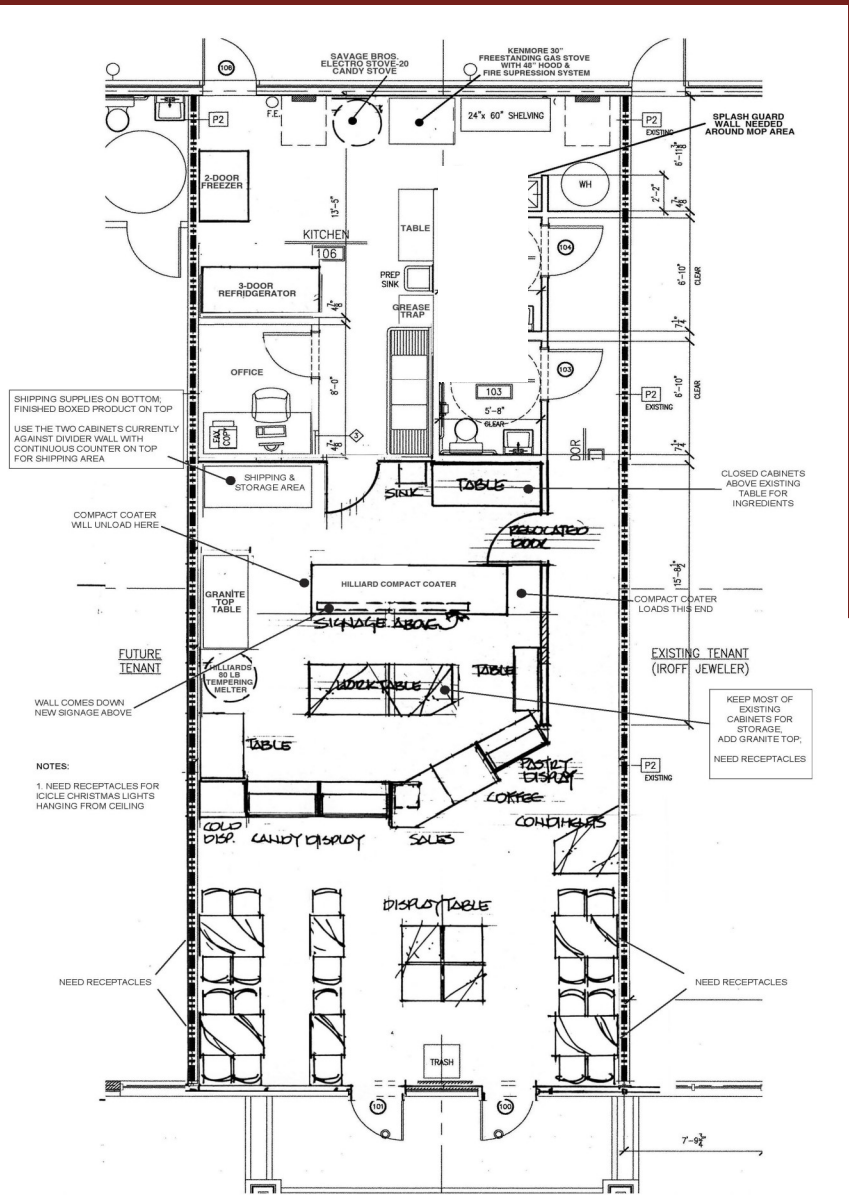

**Suite 200**  
**1,462 RSF**

**Ted Schwartz**  
 404.869.2606  
 ted@joelandgranot.com



**JOEL & GRANOT**  
 COMMERCIAL REAL ESTATE

962 Howell Mill Road, Atlanta, GA 30318  
 (ph) 404.869.2600 | (fax) 404.869.2601

The information was obtained from sources we assume are reliable. We do not doubt its accuracy, however we do not guarantee it. No liability is assumed for errors and omissions. Information is subject to changes and withdrawal without notice.